

ANCHORING DETAILS ARE FOR REFERENCE ONLY. FINAL SPECIFICATIONS AND DETAILS SHOULD BE APPROVED BY A LICENSED ENGINEER.

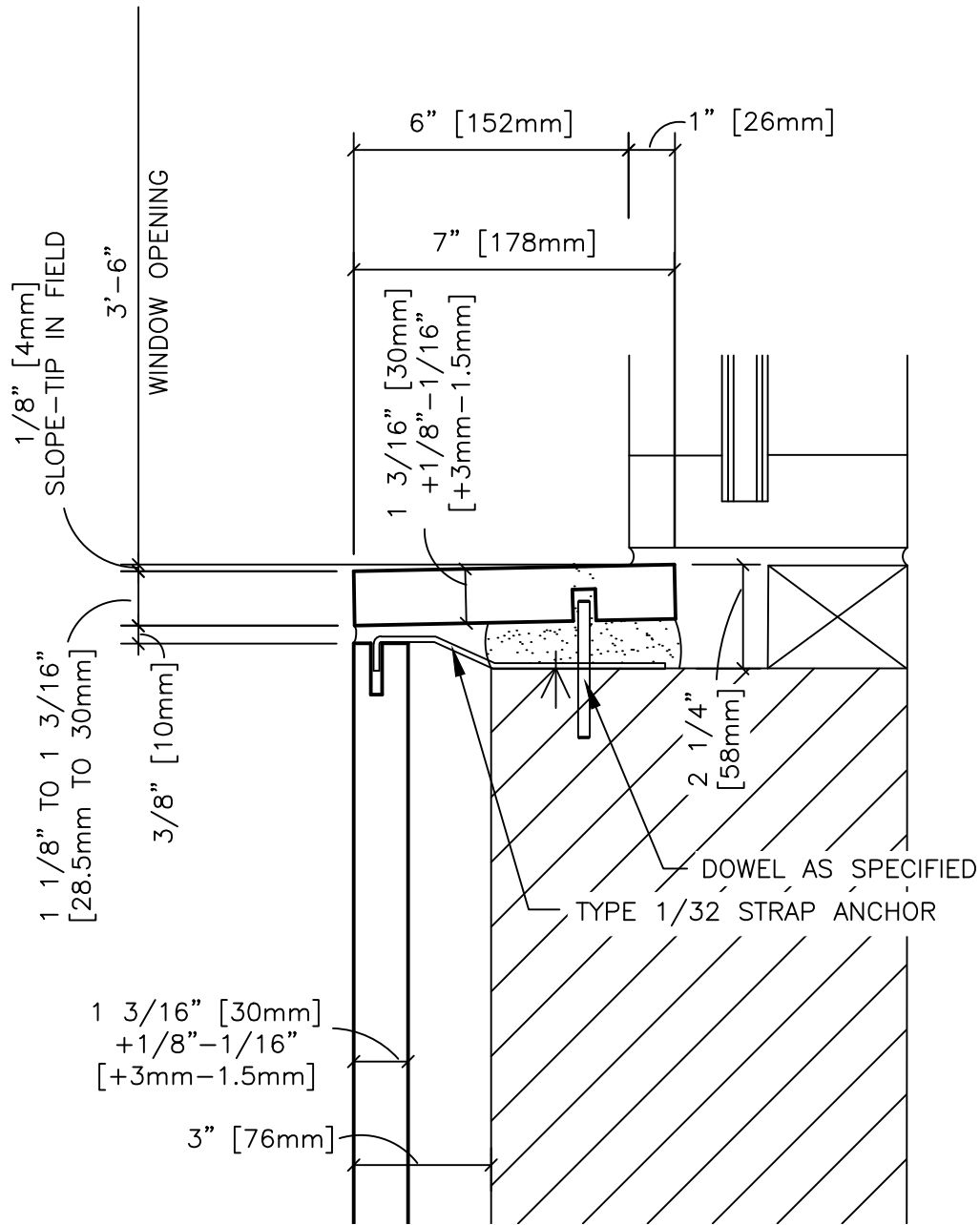

2" MIN SETTING SPACE FOR 1 3/16" THICKNESS, 2 1/2" WITH BEARING

SECTION V V

DESCRIPTION:
EXAMPLE EXTERIOR WALL - SECTION V V
30mm

SCALE:
3" = 1'-0"

DRAWN BY:
KM

DATE:
4-6-2020



COLDSPRING™

17482 GRANITE WEST ROAD, COLD SPRING, MN 56320-4578
PHONE (320) 685-3621, FAX (320) 685-5052
WWW.COLDSPRINGUSA.COM