

ANCHORING DETAILS ARE FOR REFERENCE ONLY. FINAL SPECIFICATIONS AND DETAILS SHOULD BE APPROVED BY A LICENSED ENGINEER.

TYPE 31 TORQUE REQUIREMENTS:

3/16" DIA. = 35 TO 40 IN. LBS.

1/4" DIA. = 70 TO 80 IN. LBS.

3/8" DIA. = 200 TO 220 IN. LBS

1/2" DIA. = 400 IN. LBS

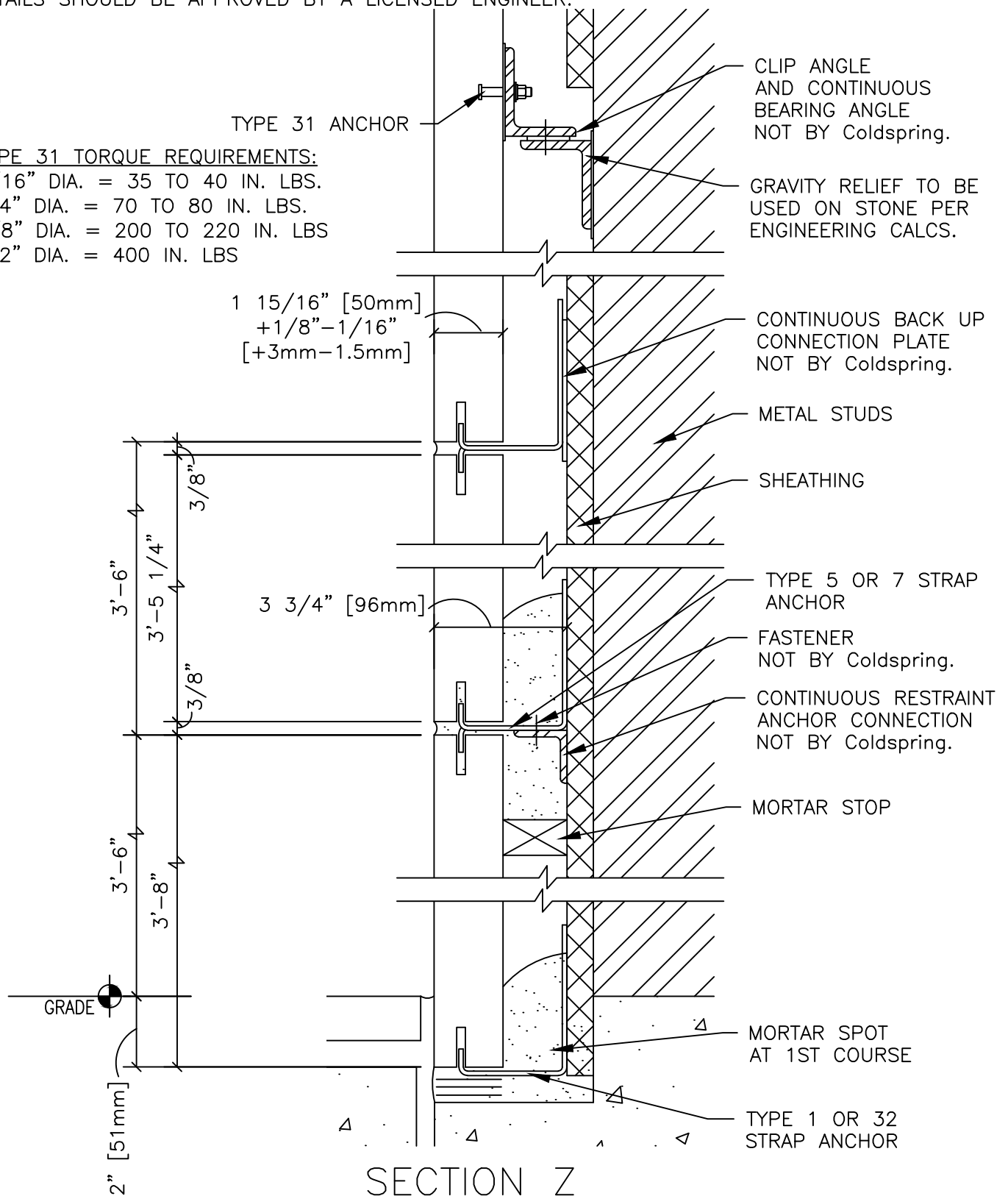

DESCRIPTION:

EXAMPLE EXTERIOR WALL - SECTION Z
50mm

SCALE:

3" = 1'-0"

DRAWN BY:

LB/KM

DATE:

4-2-2020



COLDSPRING™

17482 GRANITE WEST ROAD, COLD SPRING, MN 56320-4578
PHONE (320) 685-3621, FAX (320) 685-5052
WWW.COLDSPRINGUSA.COM