

ANCHORING DETAILS ARE FOR REFERENCE ONLY. FINAL SPECIFICATIONS AND DETAILS SHOULD BE APPROVED BY A LICENSED ENGINEER.

TYPE 31 TORQUE REQUIREMENTS:

- 3/16" DIA. = 35 TO 40 IN. LBS.
- 1/4" DIA. = 70 TO 80 IN. LBS.
- 3/8" DIA. = 200 TO 220 IN. LBS
- 1/2" DIA. = 400 IN. LBS

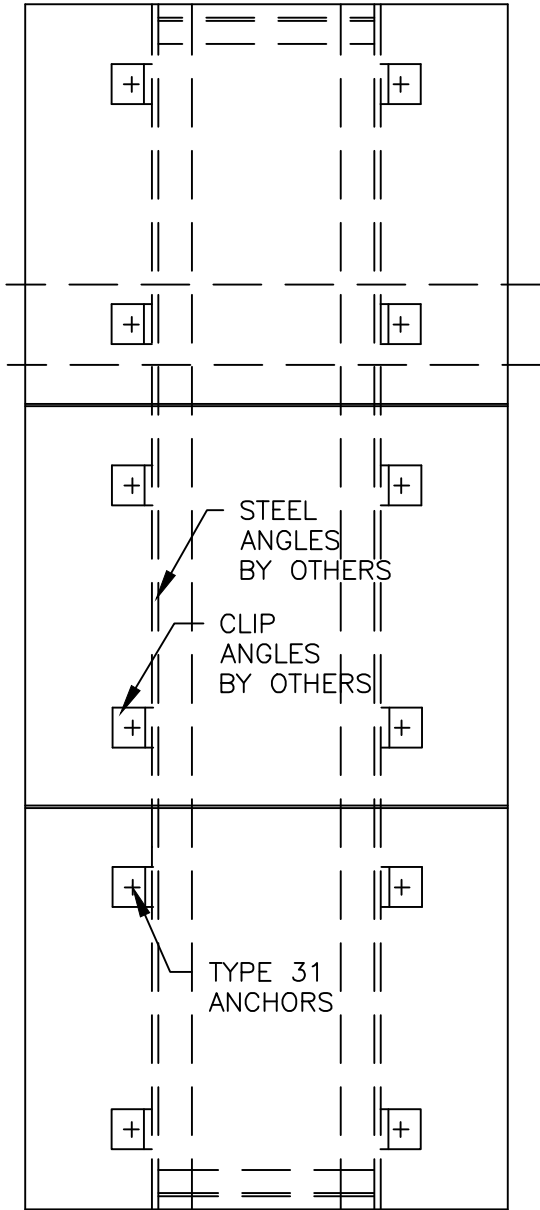

ELEVATION

1 3/16" [30mm]  
+1/8"-1/16"  
[+3mm-1.5mm]

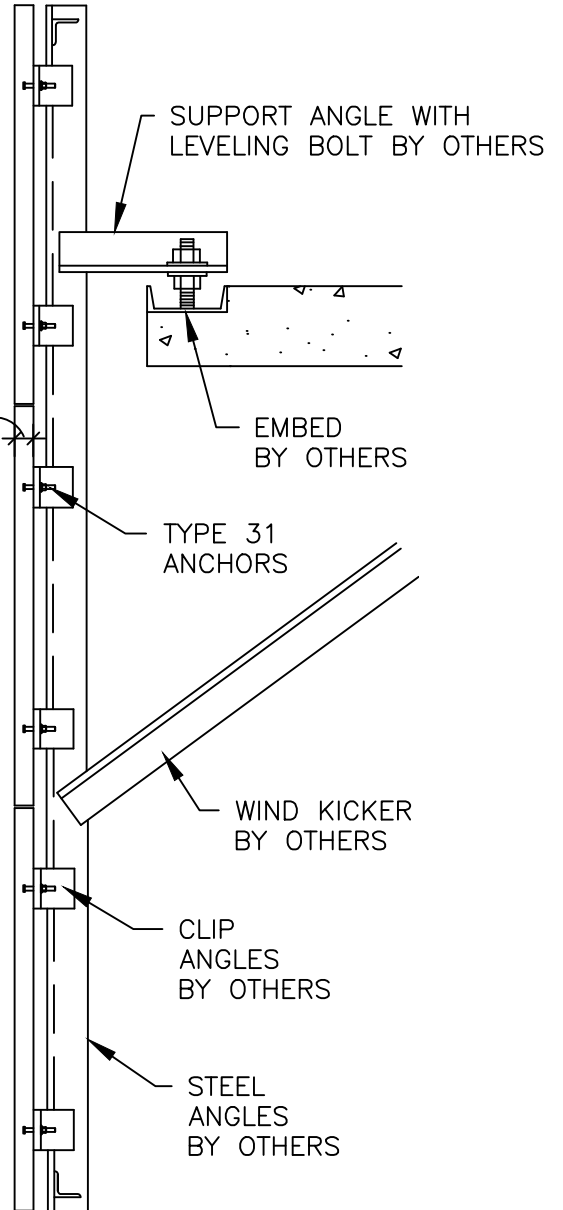

SECTION

DESCRIPTION:

STONE FACING ON TRUSS FRAME  
30mm

SCALE:

1" = 1'-0"

DRAWN BY:

LB/KM

DATE:

4-2-2020



**COLDSPRING™**

17482 GRANITE WEST ROAD, COLD SPRING, MN 56320-4578  
PHONE (320) 685-3621, FAX (320) 685-5052  
WWW.COLDSPRINGUSA.COM