

ANCHORING DETAILS ARE FOR REFERENCE ONLY. FINAL SPECIFICATIONS AND DETAILS SHOULD BE APPROVED BY A LICENSED ENGINEER.

**TYPE 31 TORQUE REQUIREMENTS:**  
 3/16" DIA. = 35 TO 40 IN. LBS.  
 1/4" DIA. = 70 TO 80 IN. LBS.  
 3/8" DIA. = 200 TO 220 IN. LBS  
 1/2" DIA. = 400 IN. LBS

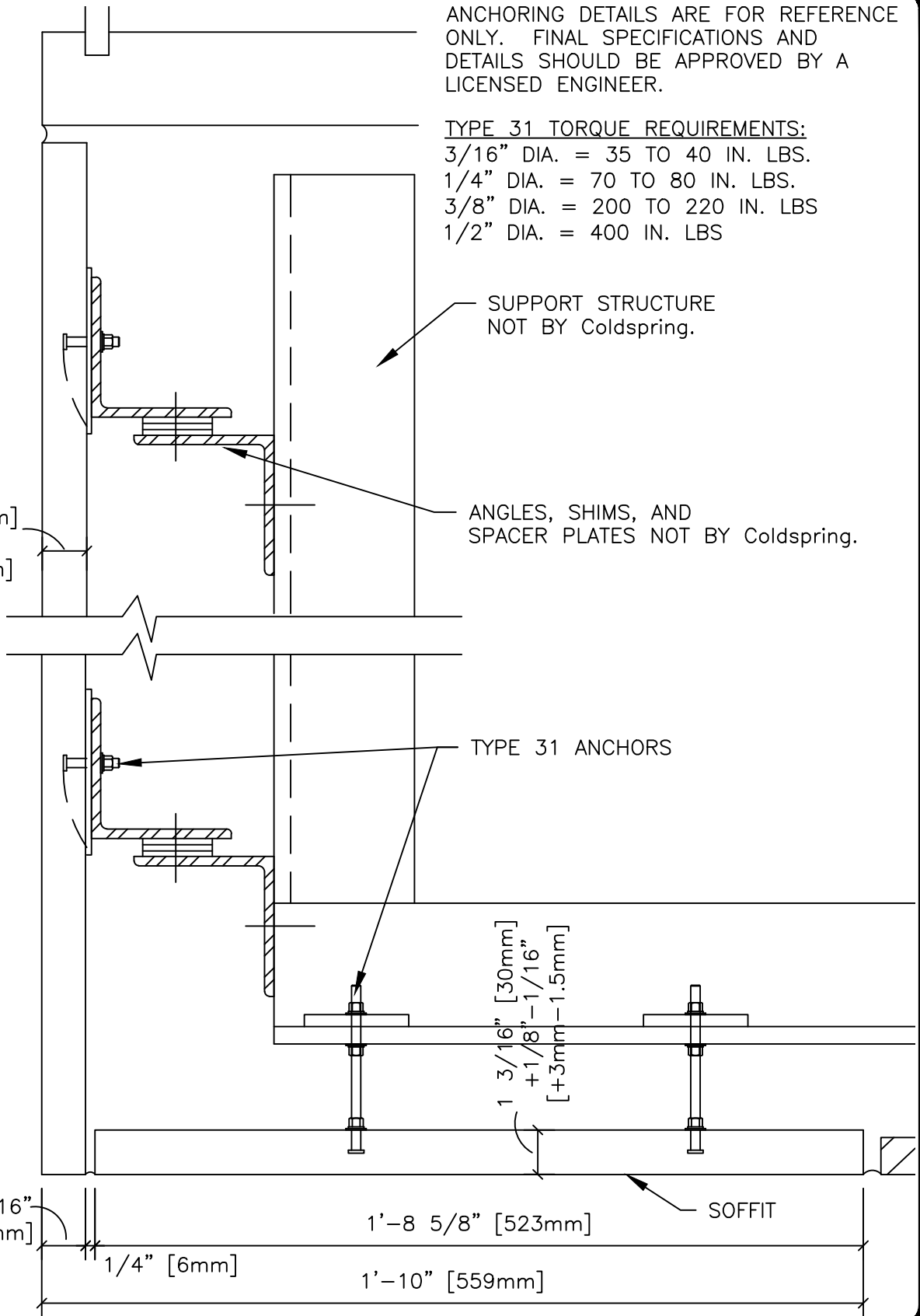

1 3/16" [30mm]  
 +1/8"-1/16"  
 [+3mm-1.5mm]

SUPPORT STRUCTURE  
 NOT BY Coldspring.

ANGLES, SHIMS, AND  
 SPACER PLATES NOT BY Coldspring.

TYPE 31 ANCHORS

1 3/16" [30mm]  
 +1/8"-1/16"  
 [+3mm-1.5mm]

1 1/8" TO 1 3/16"  
 [28.5mm TO 30mm]

1'-8 5/8" [523mm]

SOFFIT

1/4" [6mm]

1'-10" [559mm]

DESCRIPTION:

STONE FACING AND SOFFIT WITH CLIP ANGLES  
 30mm

SCALE:

3" = 1'-0"

DRAWN BY:

LB/KM

DATE:

4-2-2020



**COLDSRING™**

17482 GRANITE WEST ROAD, COLD SPRING, MN 56320-4578  
 PHONE (320) 685-3621, FAX (320) 685-5052  
 WWW.COLDSRINGUSA.COM